

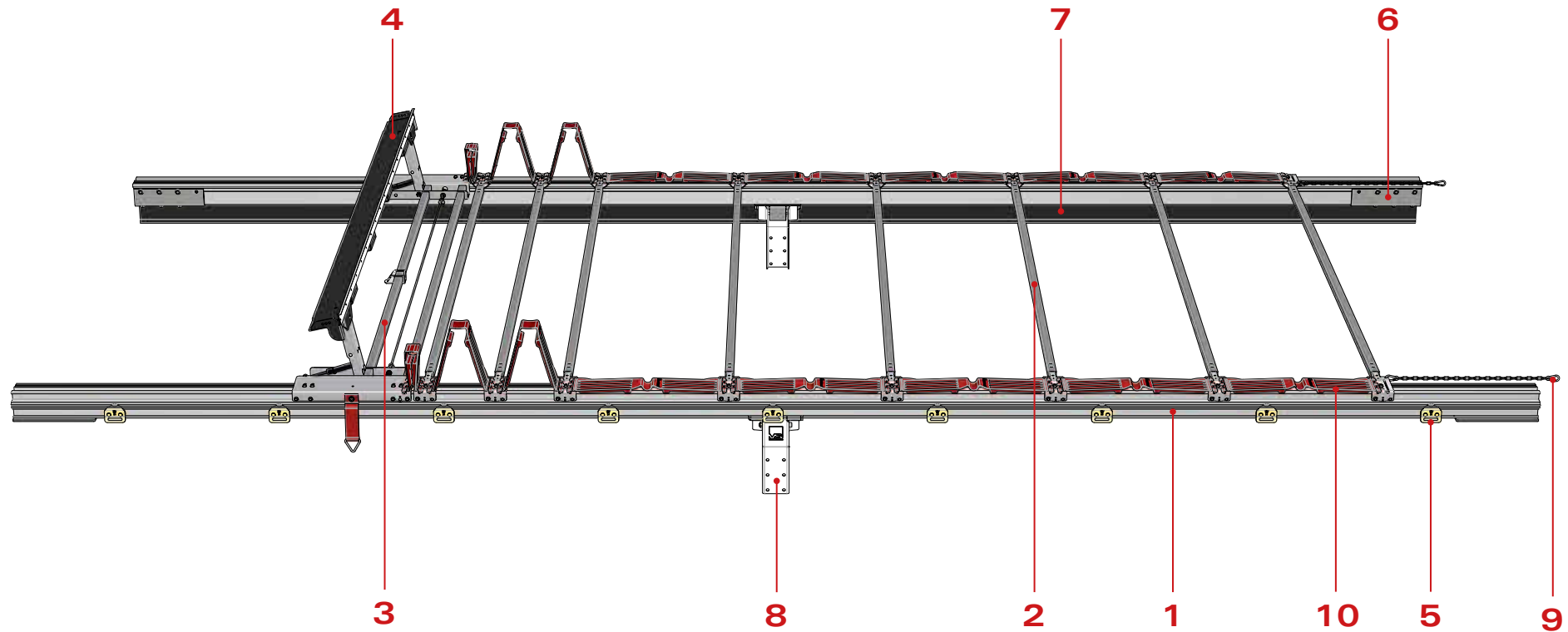

**Ω : MICRO TRIKE**

**Versus**



<b>1</b>	Micro Trike rail	<b>7</b>	PVC pelmet
<b>2</b>	Roof stick	<b>8</b>	Pillar bracket
<b>3</b>	Collapsible backside	<b>9</b>	Set accessories
<b>4</b>	Back beam	<b>10</b>	Folding plate
<b>5</b>	Trike roller	<b>11</b>	Carapax plate
<b>6</b>	Set mounting plates	<b>12</b>	Pull bar

### 1 Micro Trike rail

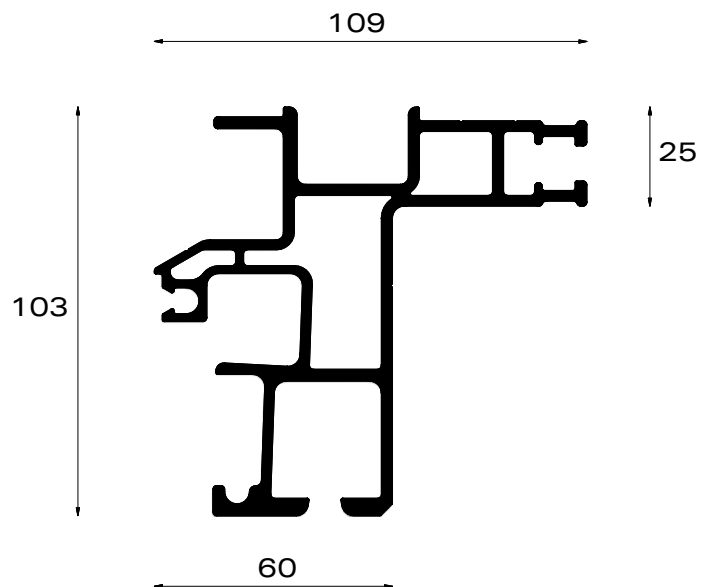

#### PART NR.

L = 4,5m 162-34450

L = 7,8m\* 162-34780

L = 8,5m\* 162-34850

$I_x : 149\text{cm}^4$   
 $I_y : 104\text{cm}^4$   
 $\pm 4 \text{ kg/m}$

\* pre-bended

### 2a Roof stick for sliding roof

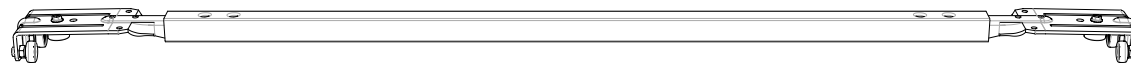

#### PART NR.

SB=2550 - Type SP 224-01001

SB=2550 - Type AS (Al) 224-03001

### 2b Roof stick for fixed roof with polyester cover



#### PART NR.

SB=2550 - Type SP 224-41101

SB=2550 - Type AS (Al) 224-43101

Mounting set roof stick fix 144-10048

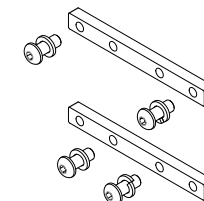

\* Roof stick screwed to rail with bolts

\* 1 set/roof stick

### 2c Roof Stick for fixed roof with tarpaulin cover

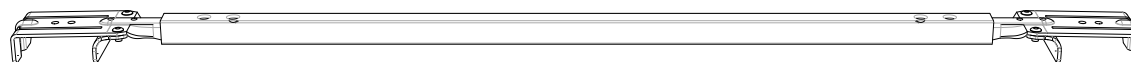

#### PART NR.

SB=2550 - Type SP 224-41211

SB=2550 - Type AS (Al) 224-43211

Mounting set roof stick fix 144-10048

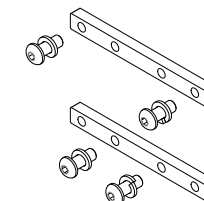

\* Roof stick screwed to rail with bolts

\* 1 set/roof stick

**3a Collapsible backside**

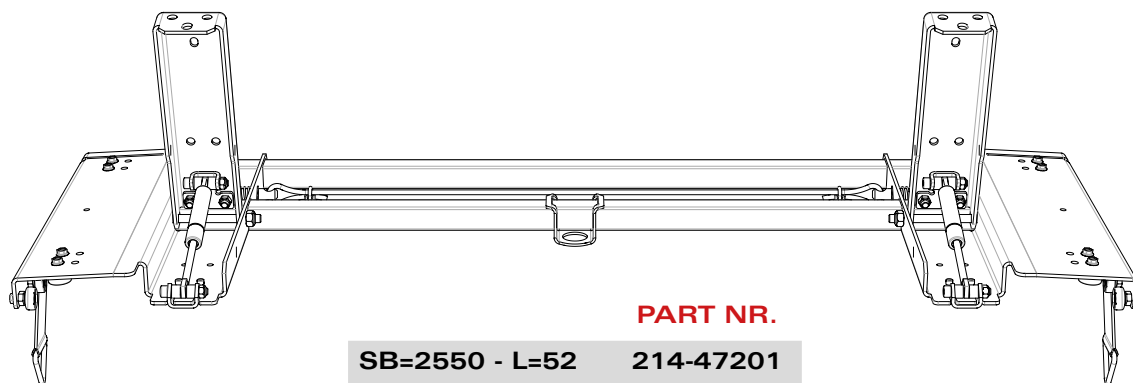

**PART NR.**  
SB=2550 - L=52    214-47201

**3b Collapsible backside for fixed roof with tarpaulin cover**

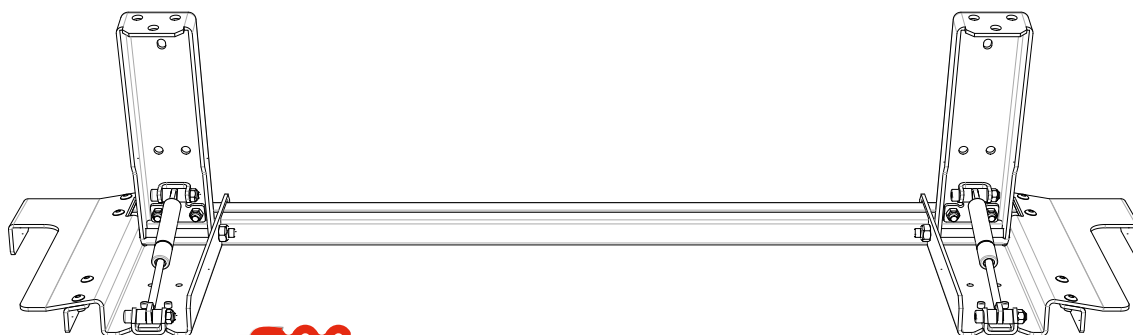

**PART NR.**  
SB=2550 - L=100    324-47201

**Front header**

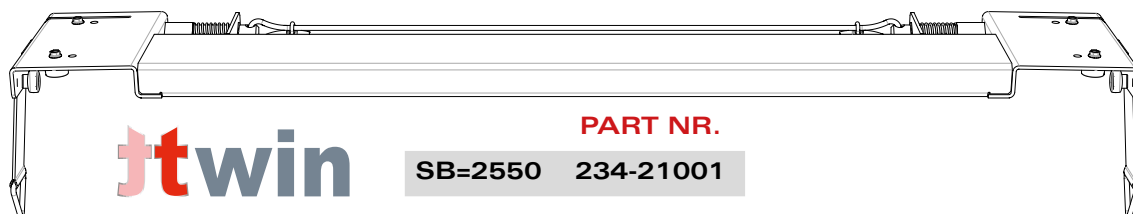

**PART NR.**  
SB=2550    234-21001

**9a Set accessories**

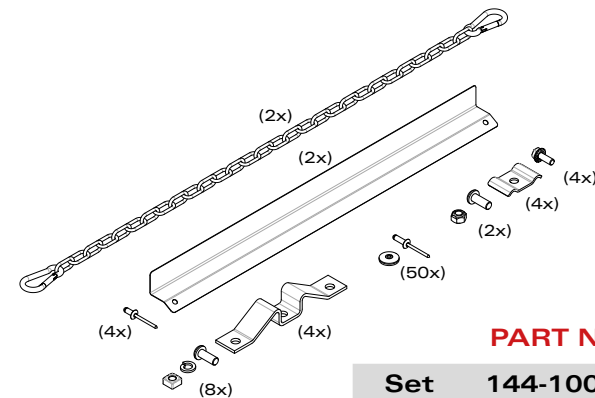

**PART NR.**  
Set    144-10001

**9b Set accessories Twin**

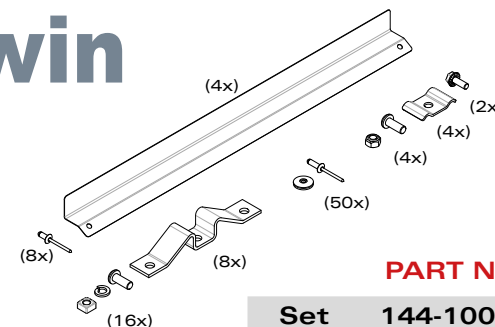

**PART NR.**  
Set    144-10018

\* Micro Trike Twin sliding roof: this set replaces the basic set accessories (144-10001)!

**9c Set lock collapsible backside**

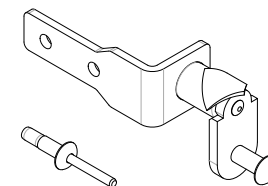

**PART NR.**  
Set    144-10086

**9d Set accessories external unlocking**



**PART NR.**  
Set    144-10174

### 4a Back beam

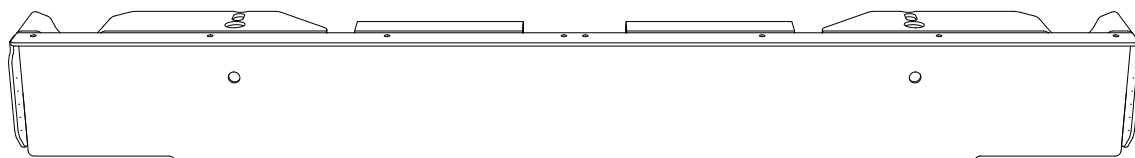

PART NR.	
SB=2550 - 125Z	193-11001
Mounting set	144-10022

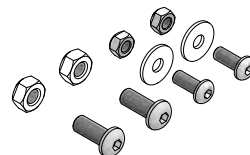

### 10 Folding plate

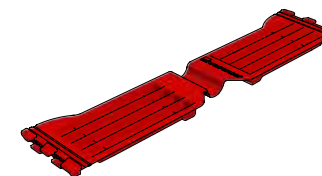

PART NR.	
Type 400	242-01004
Type 500	242-01005
Type 600	242-01006
Type 700	242-01007
Type 570	242-01057
Type 650	242-01065

### 4b Back beam

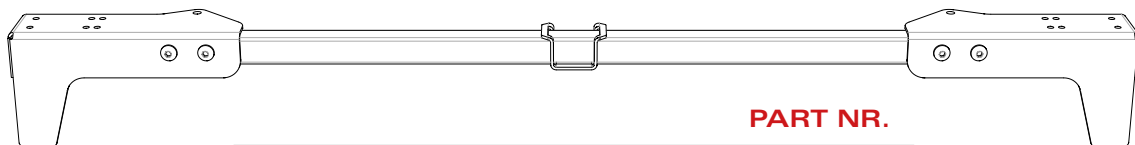

PART NR.	
Set back beam tube 30x30mm	144-10037
Tube 30x30x2mm	112-07001

### Rain strip for back beam (4a)

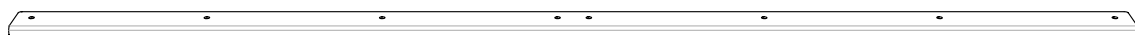

PART NR.	
SB=2550	192-01601

### Rain strip for front header

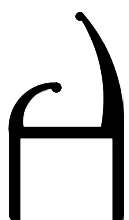

**ttwin**

PART NR.	
Rain strip SB=2550	192-01606
PVC pelmet L = 2,6m (black)	242-20001
Mounting strip 30x5mm L= 2,6m	292-07001

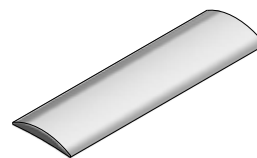

### 7 PVC pelmet (black)

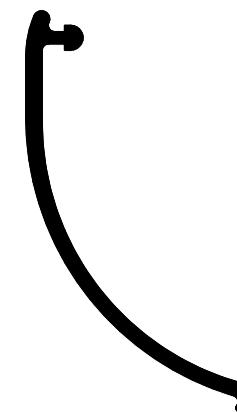

PART NR.	
L = 9m	242-15109
L = 14m	242-15114

### 12 Pull bars & webbing

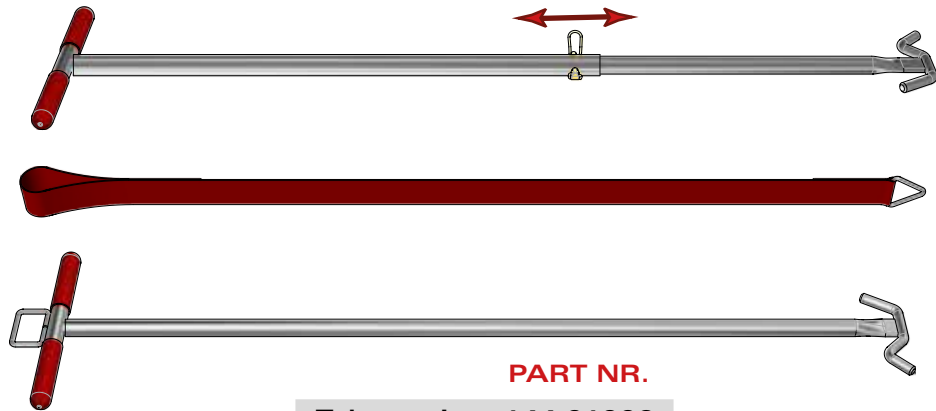

**PART NR.**

Telescopic	144-01006
Webbing	144-01500
Standard	144-01003

### 8 Pillar bracket

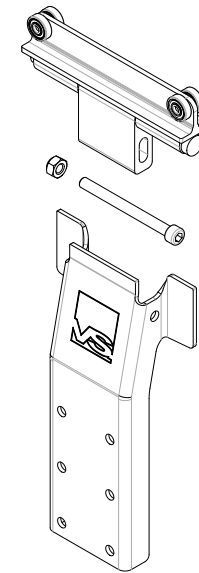

**PART NR.**

Bracket	264-01001
Bolt & nut	144-10015
Plate	262-05007

### 6 Set mounting plates

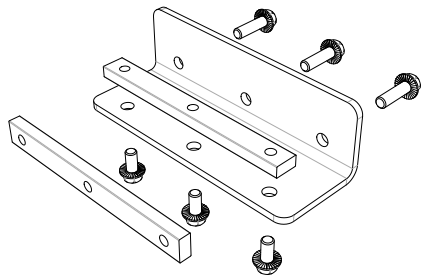

**PART NR.**

154-03041

\* contains 4x the parts of the picture

### 5 Trike roller

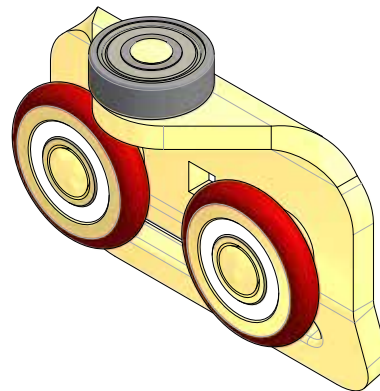

**PART NR.**

284-10024

### 11 Carapax plate



**PART NR.**

291-03004

\* only needed for roof with Carapax cover

## For roof sticks

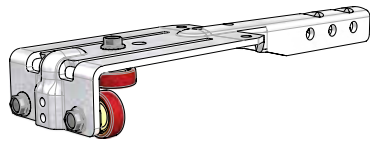

**Assembled bracket**

**PART NR.**

**174-02001**



**Roller bearing plastic**

**PART NR.**

**132-01001**



**Bolt tensilock M6x16mm**

**PART NR.**

**091-23001**

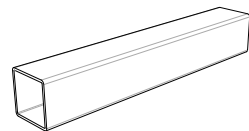

**Tube 30x30x1,5mm**

**PART NR.**

**L = 2185mm 112-01003**

## For collapsible backside

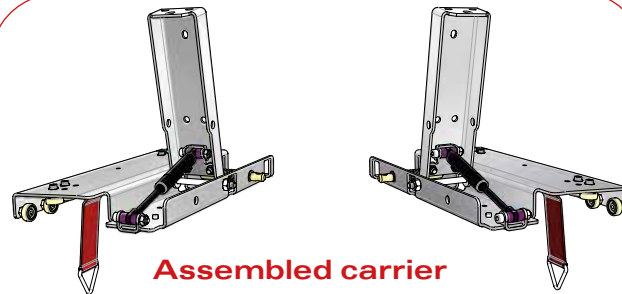

**Assembled carrier**

**PART NR.**

**Left 204-47201**

**Right 204-47202**

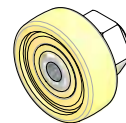

**Roller bearing steel**

**PART NR.**

**132-03001**



**Bolt tensilock M6x16mm**

**PART NR.**

**091-23001**

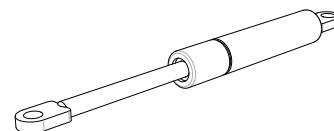

**Gas spring 700N**

**PART NR.**

**302-01001**

## For accessories set

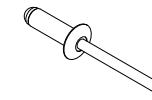

**Rivet & washer**

**PART NR.**

**50 pieces 144-10003**

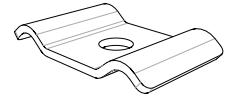

**Rope clamp**

**PART NR.**

**292-01001**

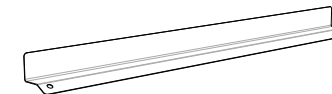

**Protection plate**

**PART NR.**

**142-06006**

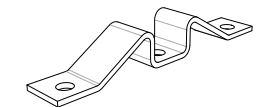

**Locking nose**

**PART NR.**

**142-05002**

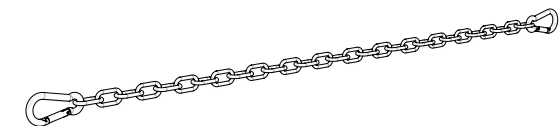

**Chain with 2 hooks**

**PART NR.**

**142-07001**

## For mounting set

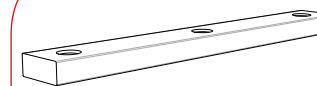

**Mounting block**

**PART NR.**

**152-02001**

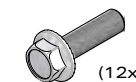

**Bolt tensilock M10x20mm**

**PART NR.**

**091-23004**

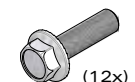

**Bolt tensilock M10x35mm**

**PART NR.**

**091-23002**



**Versus-Omega**

Nijverheidslaan 1527a  
B-3660 Oudsbergen  
Belgium

t. +32 89 320 190  
f. +32 89 320 199  
e. [info@versus-omega.com](mailto:info@versus-omega.com)  
w. [www.versus-omega.com](http://www.versus-omega.com)

