

THE BOTTLE

New Patented Penta folding system

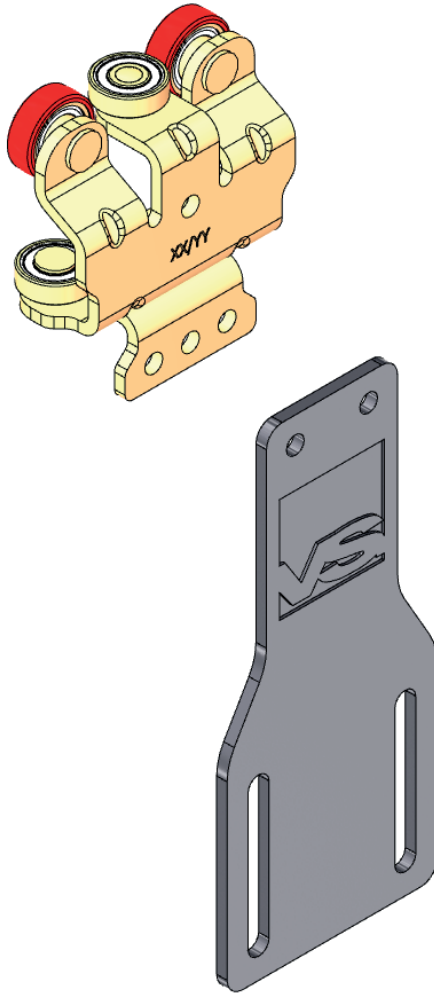



What does it contain?

1 The Penta roller

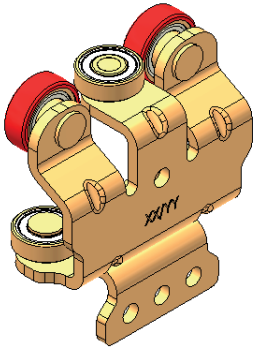

Part nr. : 284-50020

2 The Bottle



Part nr. : 282-50010

3 The Rivets

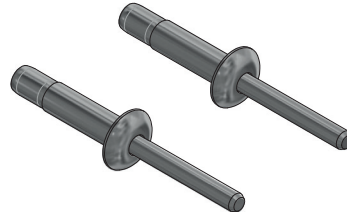

Part nr. : 091-01002

4 The Velcro

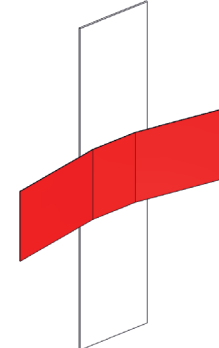

Part nr. : 312-08006

5 The folding strip

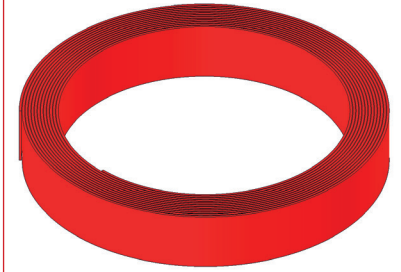

Part nr.: 242-06209, L = 9 m.
Part nr.: 242-06214, L = 14 m.

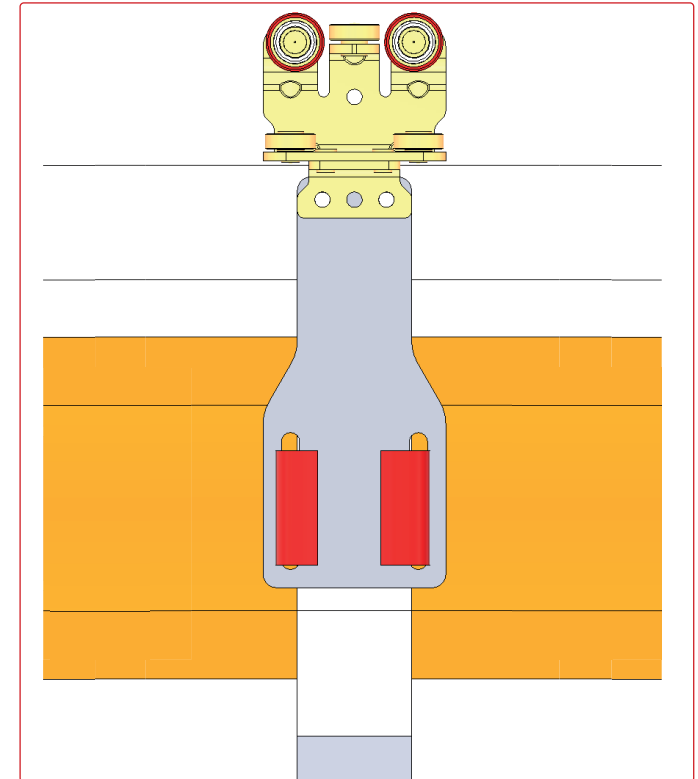
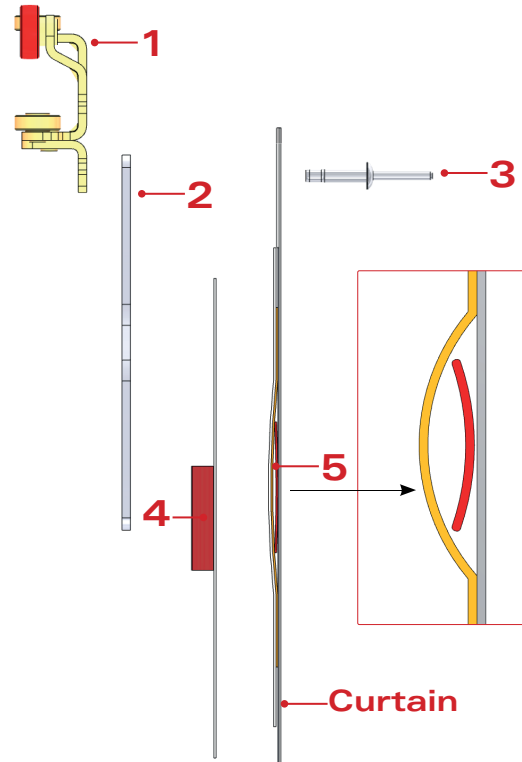
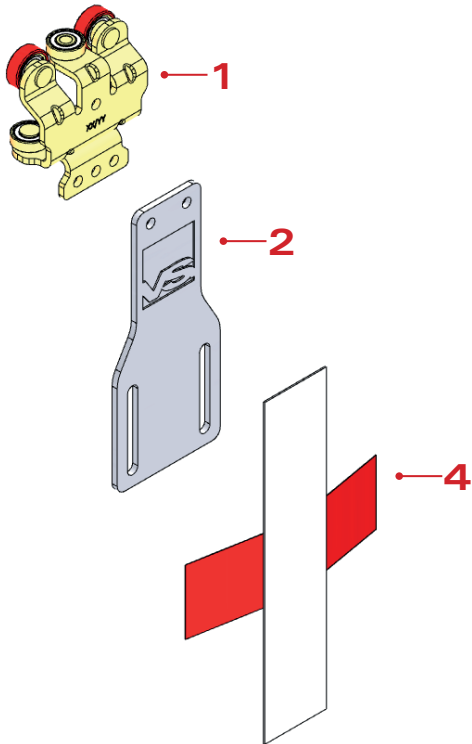

How does “the Bottle” work?

- 1 The pocket on the curtain (for the folding strip) needs to be placed at 15 cm from the top.

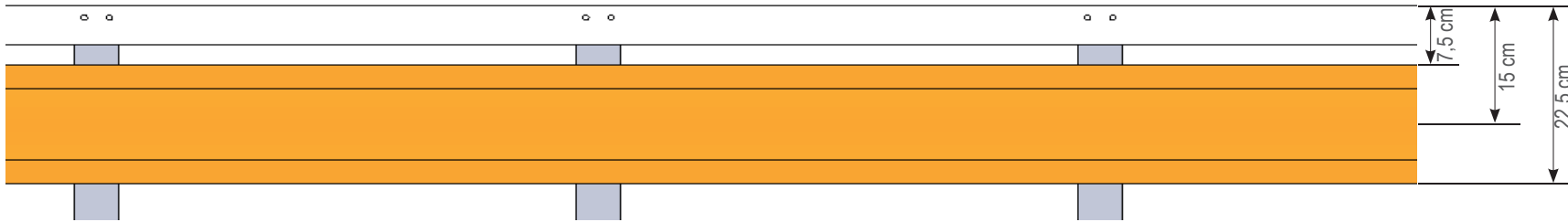

- 2 This 15 cm is exactly the height where “the Bottle” has its slots.

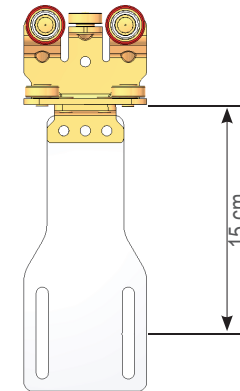

- 3 The Velcro is vertically welded, over the pocket, at the same 15 cm from the top.

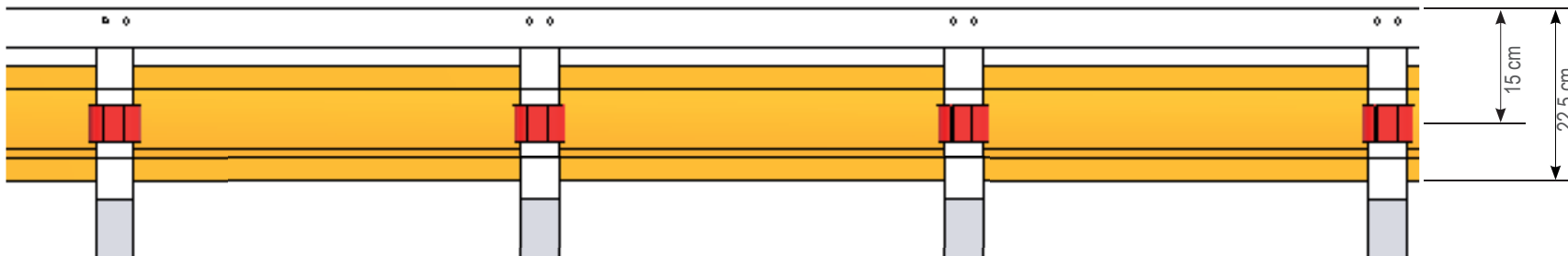

How does “the Bottle” work?

- 4 The penta roller needs to be riveted together with the bottle to the curtain. Secondly the Velcro will be inserted into the slides of the bottle.

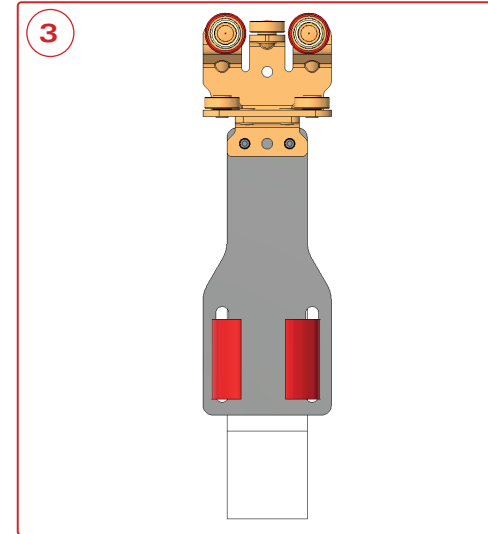
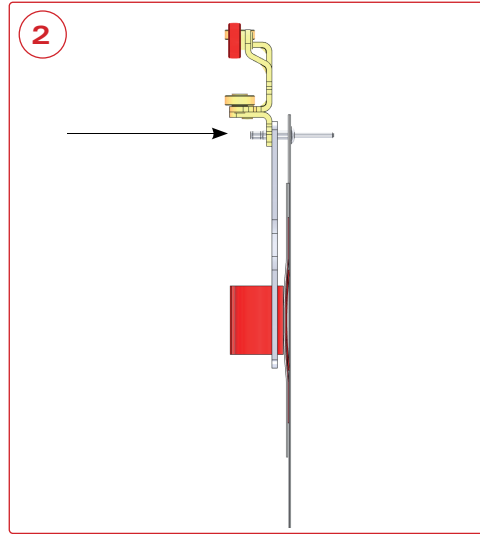
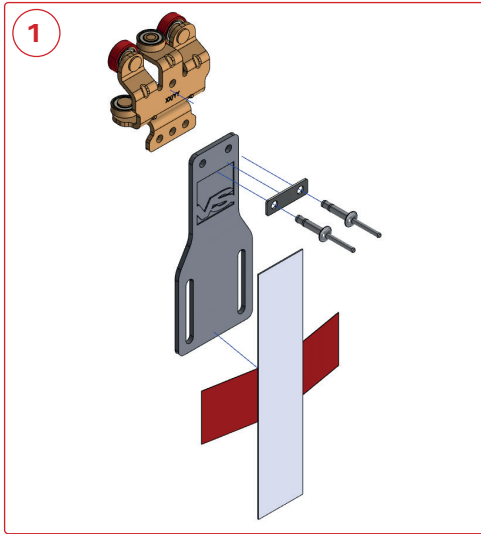

- 5 While opening the curtain, the folding strip will be hold against “the Bottles”. The curtain between “the Bottles” will fold automatically to the outside.

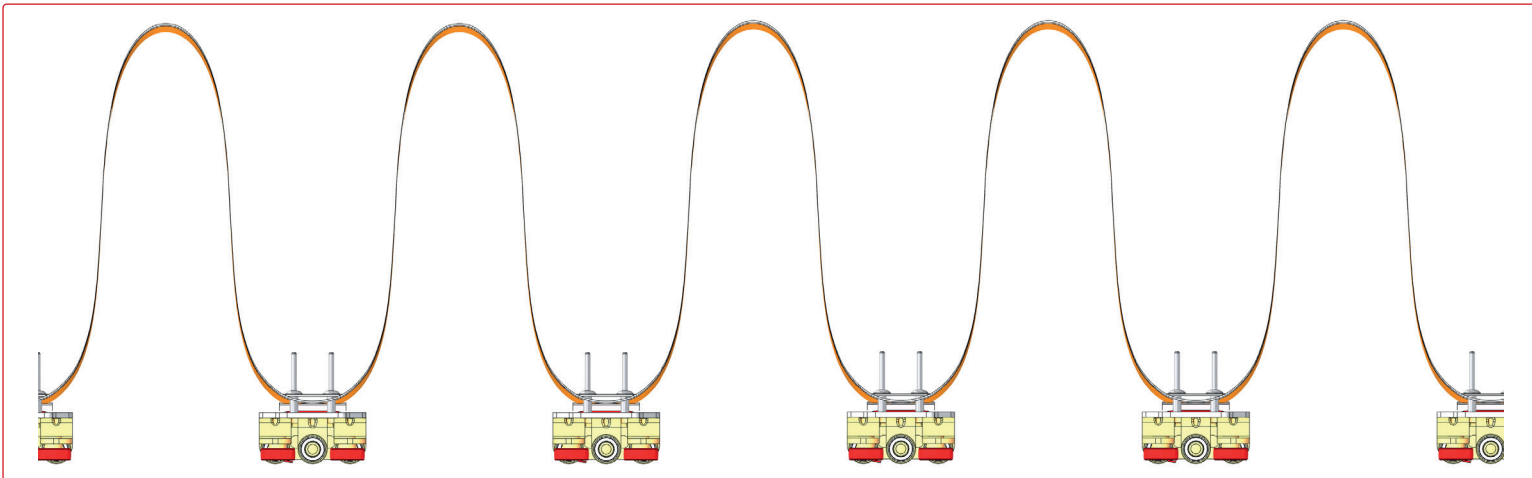

How to design the curtain for use with“ the Bottle”?

- 1 First weld both, vertically and horizontally the 4,8 cm weldable tape to the curtain in max 60 cm squares.



- 2 Secondly, weld the pocket for the folding strip as shown horizontally over the weldable tapes.

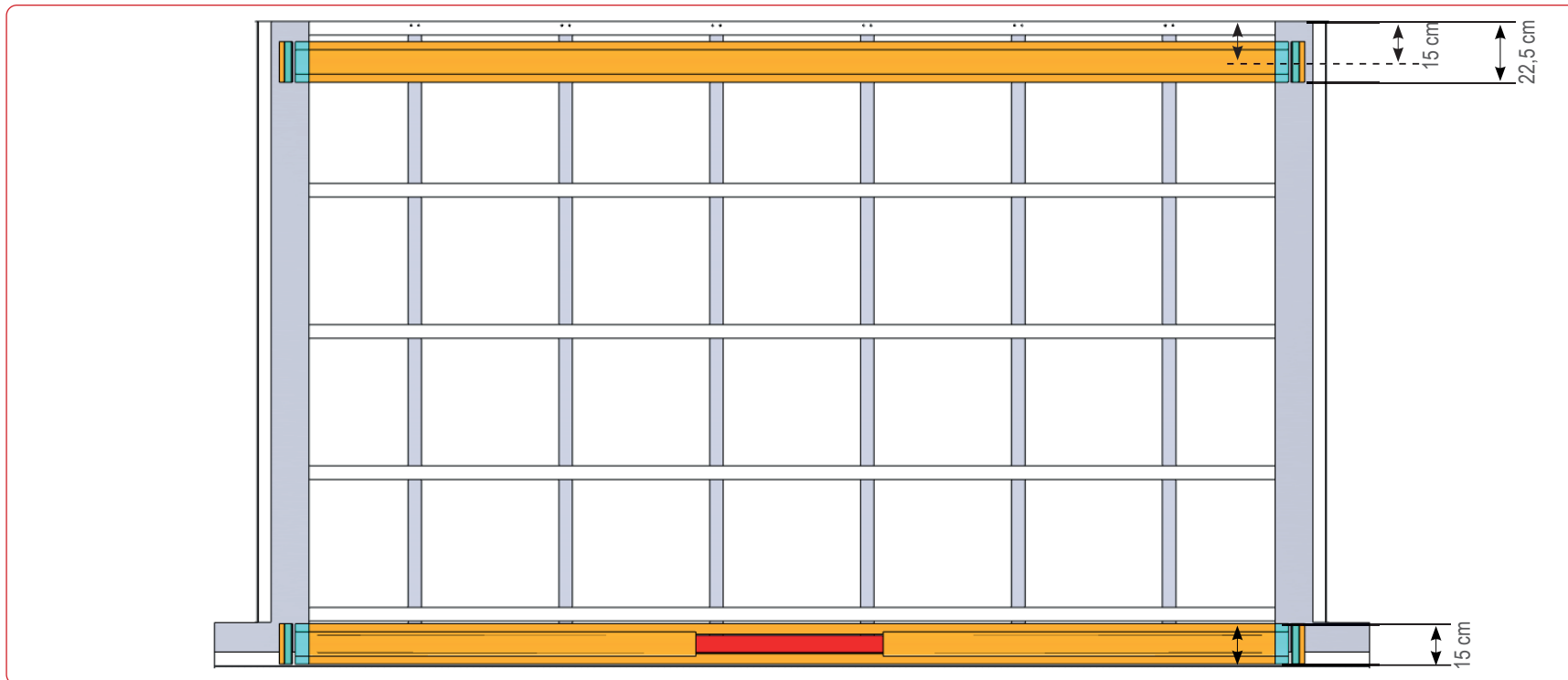

How to design the curtain for use with“ the Bottle”?

- 3 Attention: Keep both ends of the pockets accessible and insert a rope before welding, ensuring an easy insert of the folding strip.

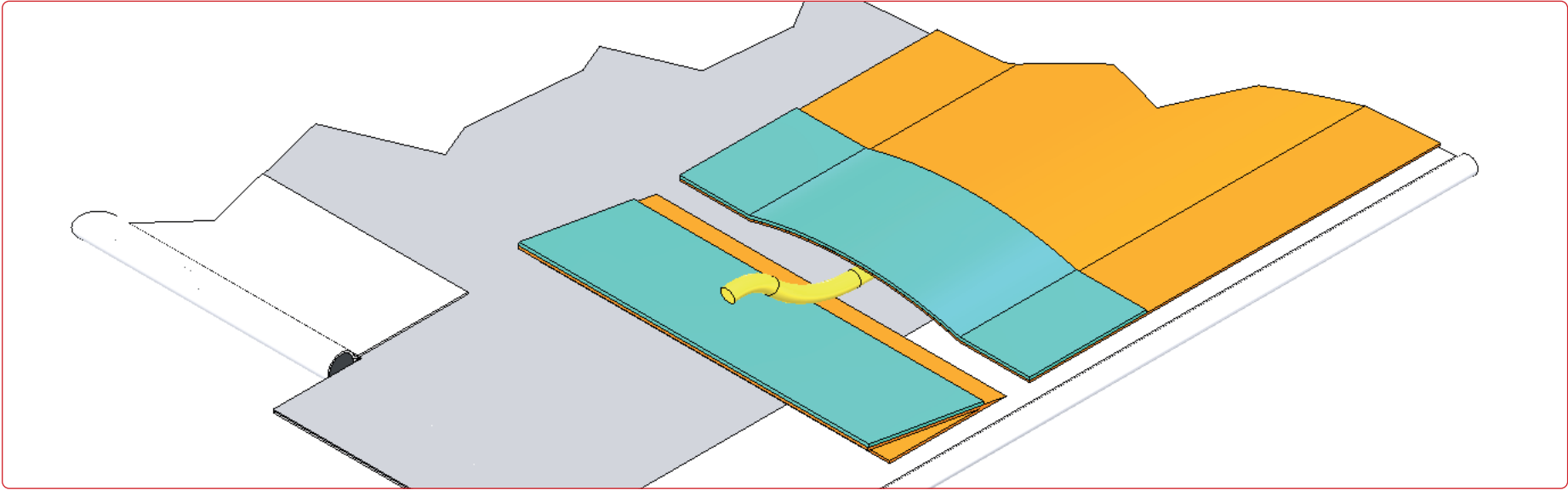

- 4 Finally weld the Velcro straps at 15 cm from the top, exactly on the vertical weldable tapes.

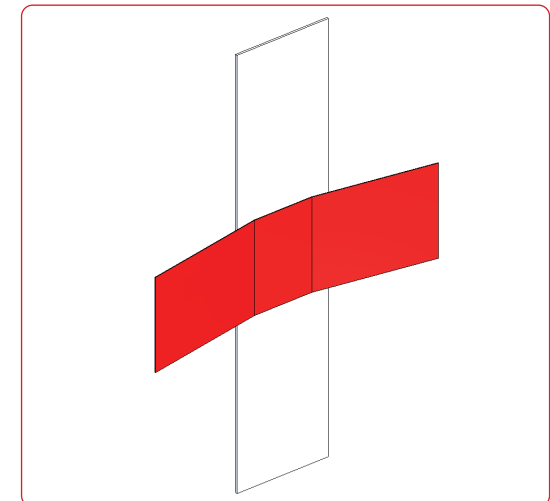
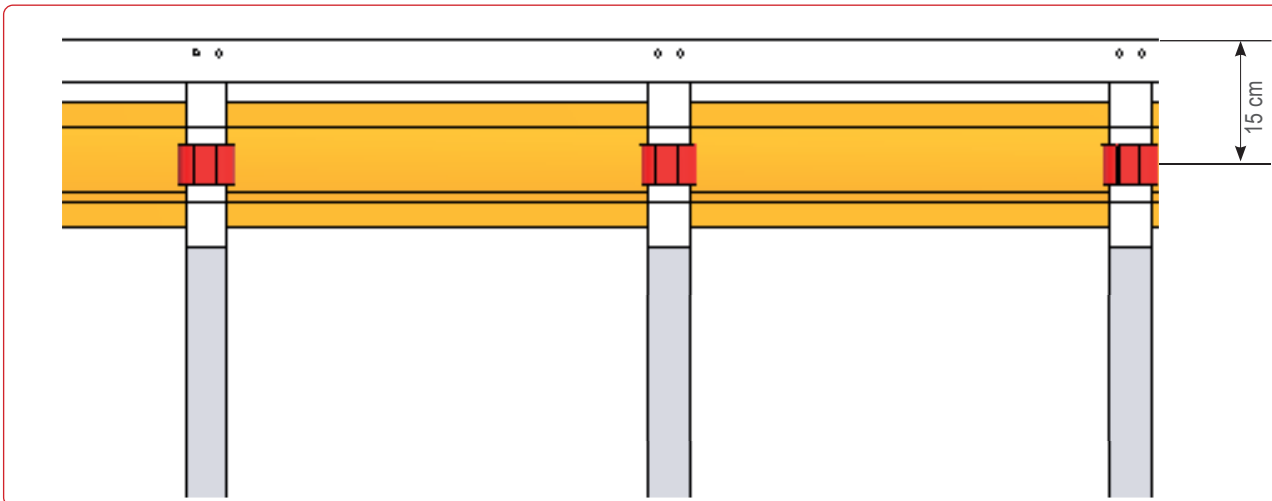

How to design the curtain for use with “the Bottle”?

- 5 Insert the folding strip into the curtain using the rope as mentioned in point 3.

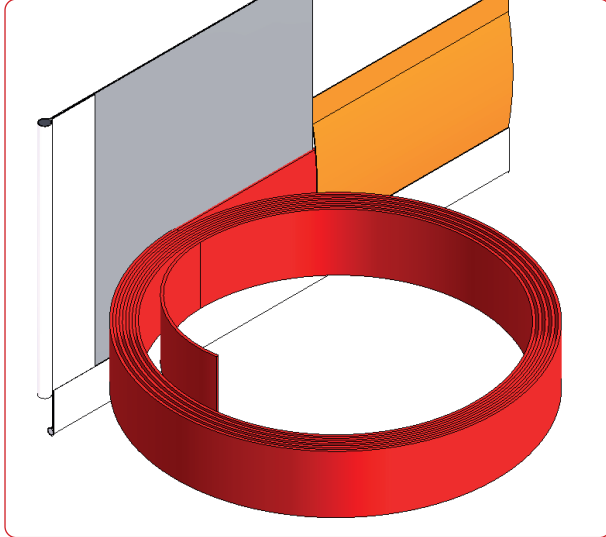

- 6 Fix the curtain to the Penta rollers and “the Bottle” using the rivets (see page 4, paragraph 4), and strap the weldable tape into the slots of “the Bottle”

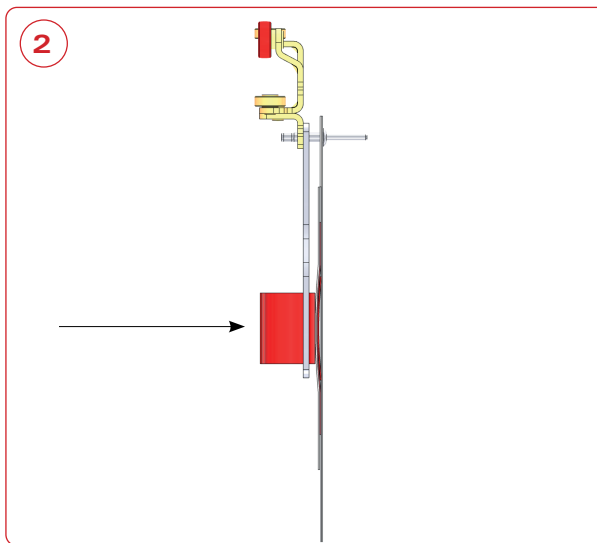
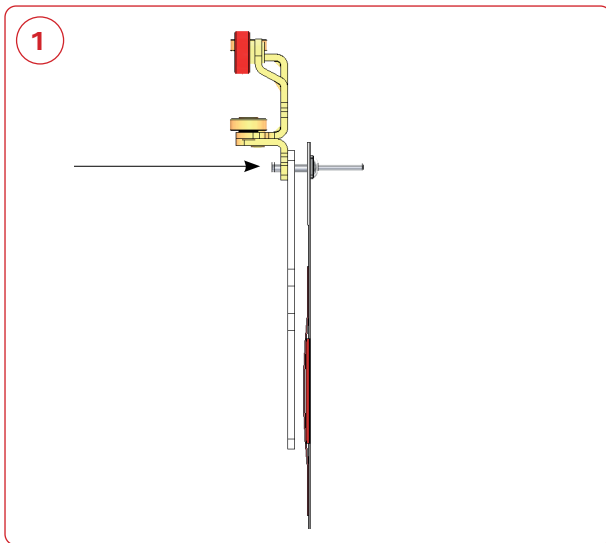

How to design the curtain for use with“ the Bottle”?

- 7 While opening the curtain for the first time, help it to fold (manually) into the right direction. Keep it in the folded position for a while. This creates a memory effect for future opening.

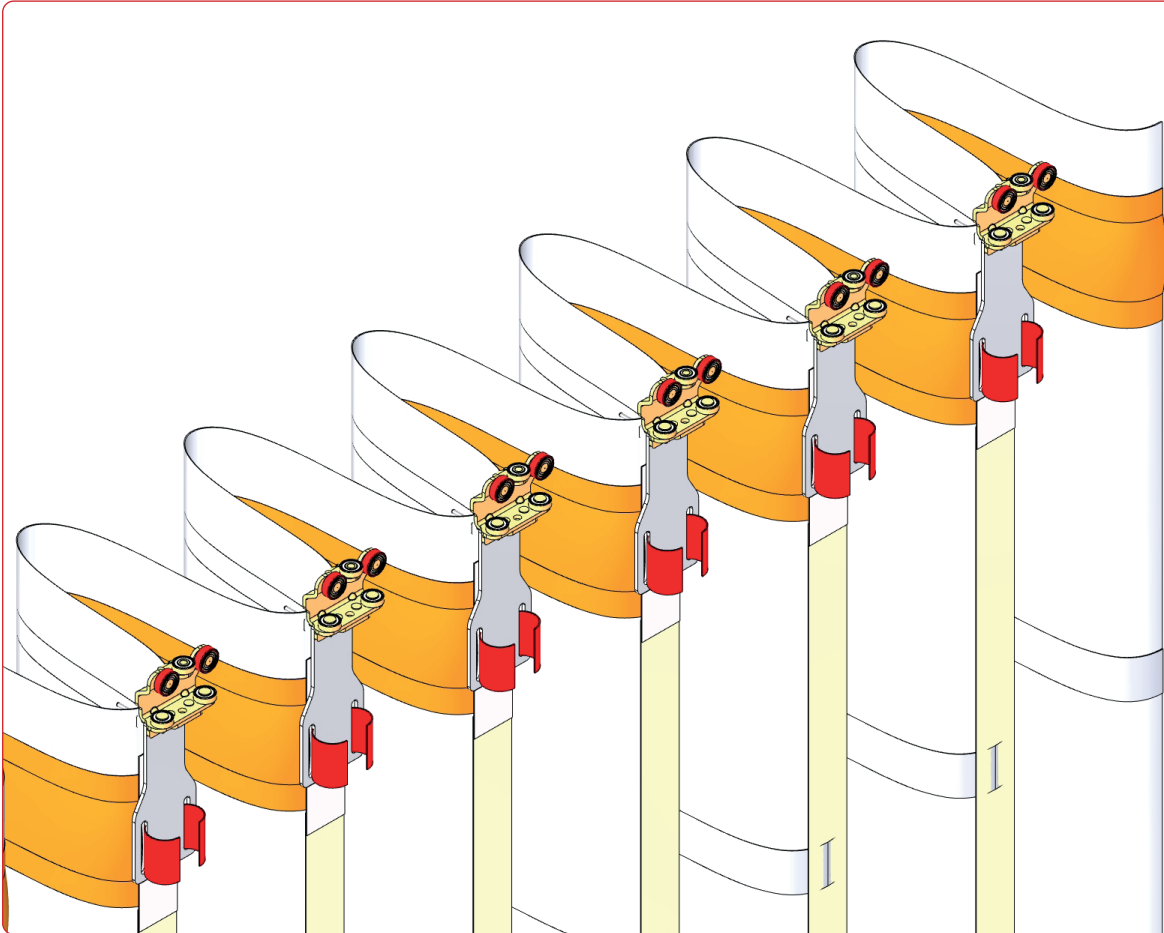



Versus-Omega
Nijverheidslaan 1527a
B-3660 Oudsbergen
Belgium

t. +32 89 320 190
f. +32 89 320 199
e. info@versus-omega.com
w. www.versus-omega.com