

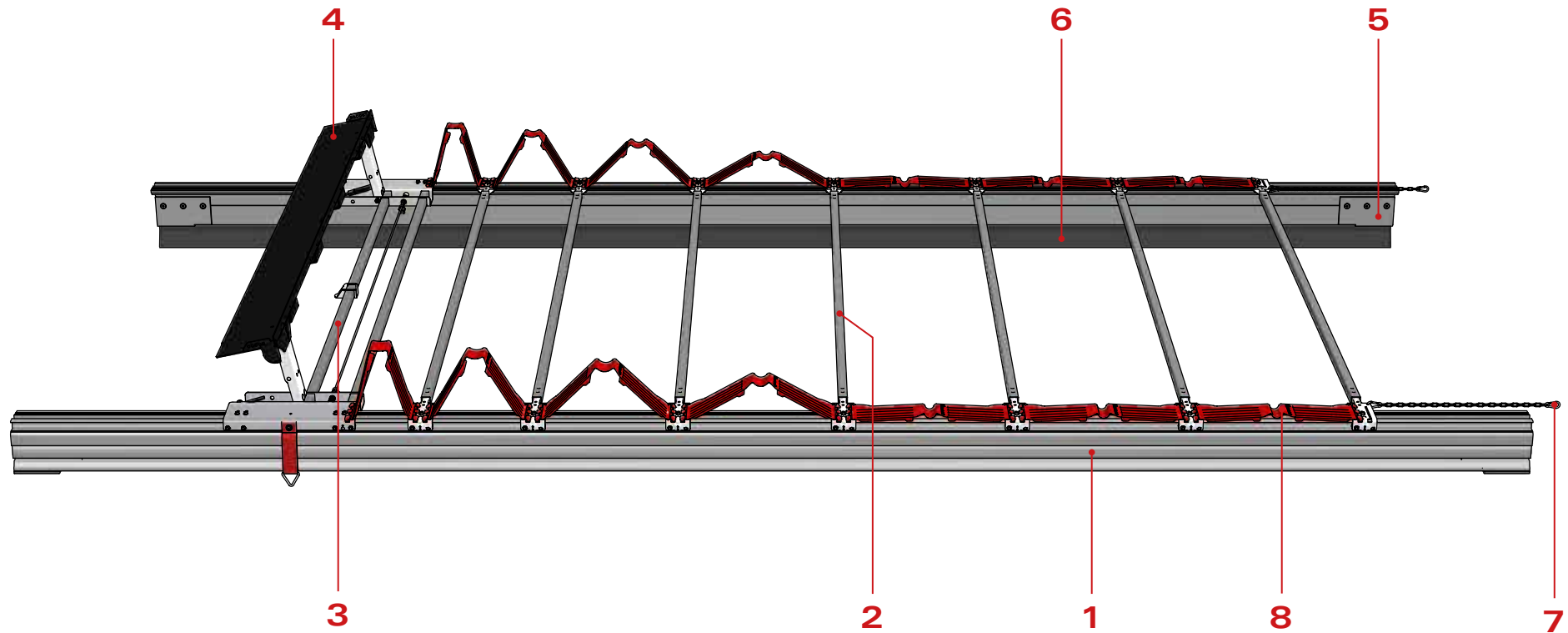

Ω : ALTO PENTA

Versus



1	Alto Penta rail	6	PVC pelmet
2	Roof stick	7	Set accessories
3	Collapsible backside	8	Folding plate
4	Back beam	9*	Carapax plate
5	Set mounting plates	10*	Pull bar

* Not visible on the composition drawing above.

1 Alto Penta rail

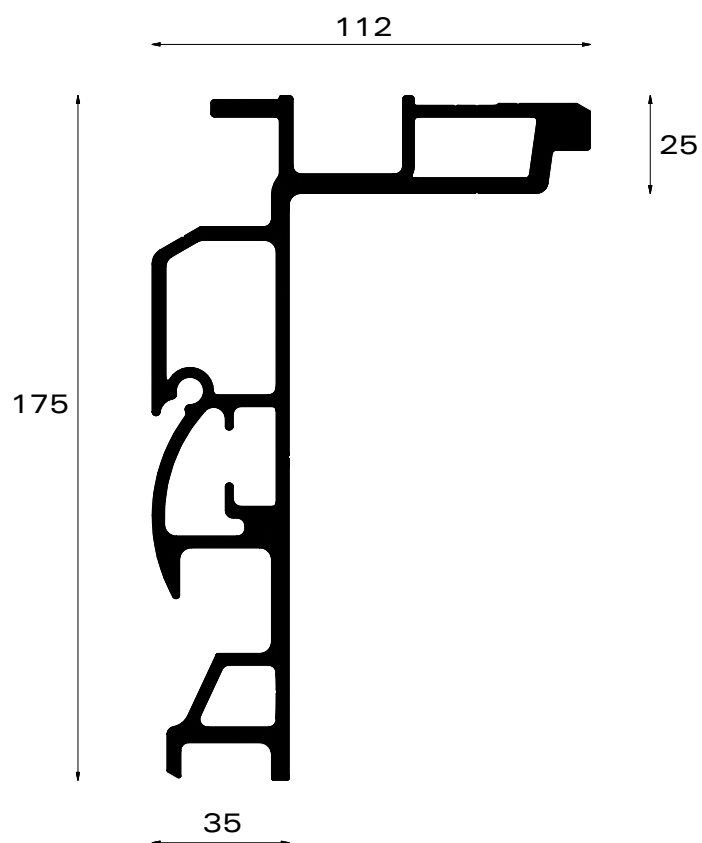

PART NR.

L = 7,8m	162-37780
----------	-----------

L = 8,5m	162-37850
----------	-----------

* L = 13,6m	162-37136
-------------	-----------

* profile with pre-bending & milling

I_x : 711cm⁴

I_y : 213cm⁴

± 6,1 kg/m

2a Roof stick for sliding roof



PART NR.

SB=2550 - Type SP	224-01001
-------------------	-----------

SB=2550 - Type AS (Al)	224-03001
------------------------	-----------

2b Roof stick with anti-fly hook for sliding roof

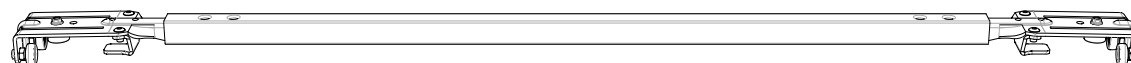

PART NR.

SB=2550 - Type SP	224-91001
-------------------	-----------

SB=2550 - Type AS (Al)	224-93001
------------------------	-----------

2c Roof Stick for fixed roof with tarpaulin cover



PART NR.

SB=2550 - Type SP	224-41201
-------------------	-----------

SB=2550 - Type AS (Al)	224-43201
------------------------	-----------



* Roof stick riveted to rail with monobolts

3a Collapsible backside

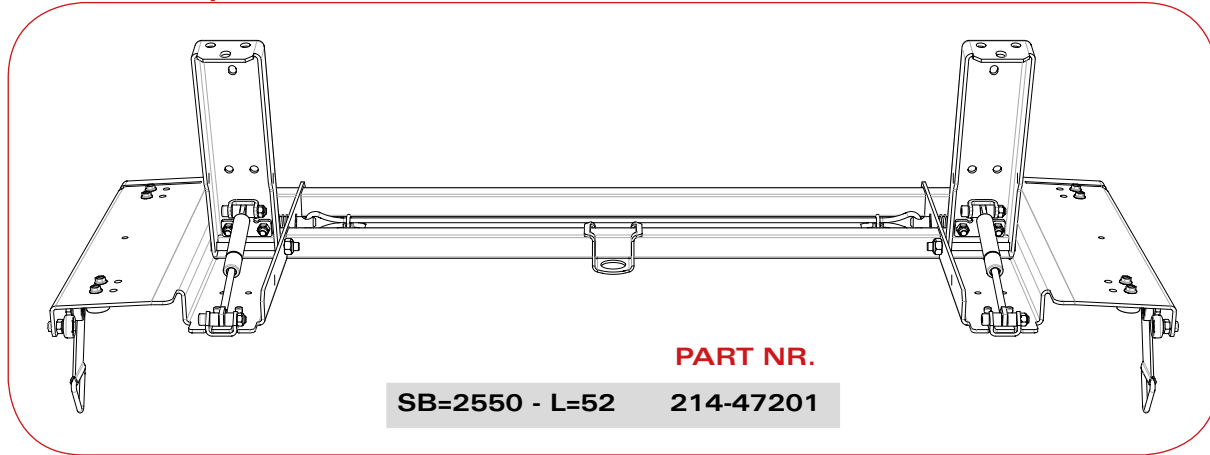

3b Collapsible backside for fixed roof with tarpaulin cover

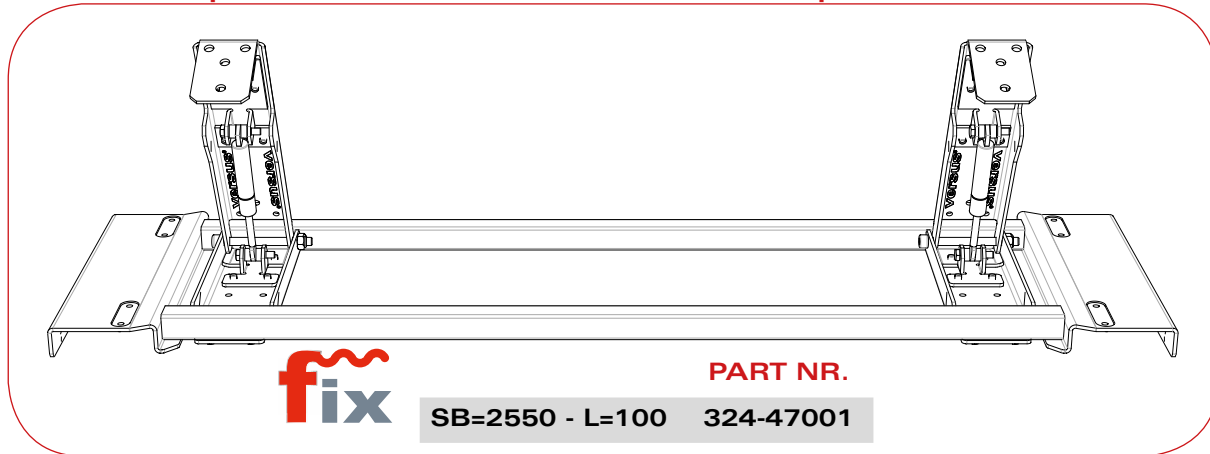

Front header

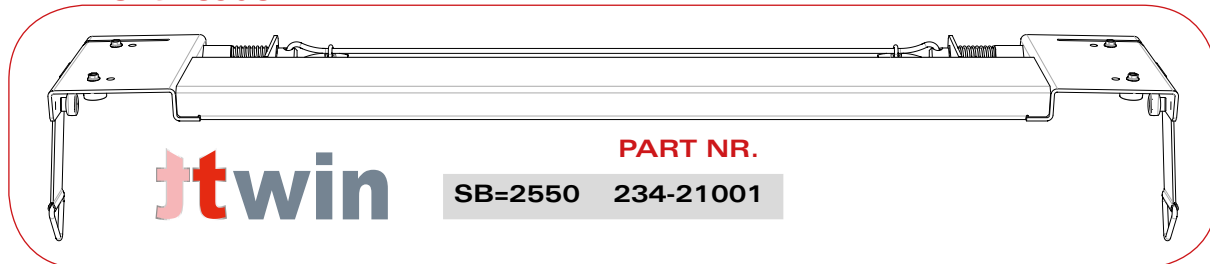

5 Set mounting plates

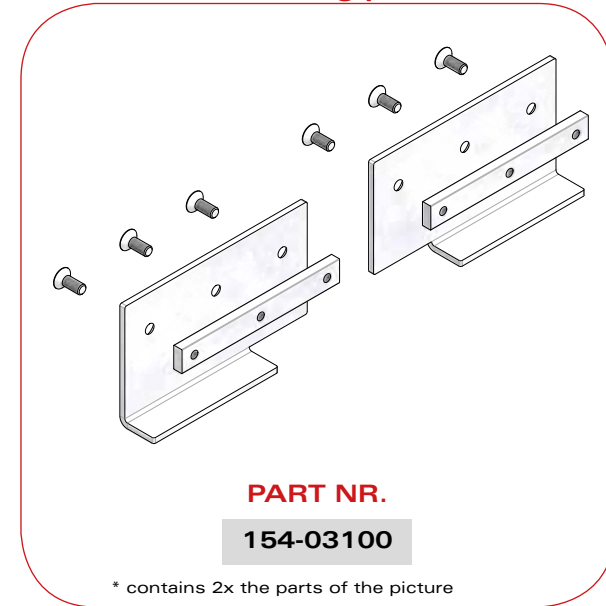

6 PVC pelmet (black)

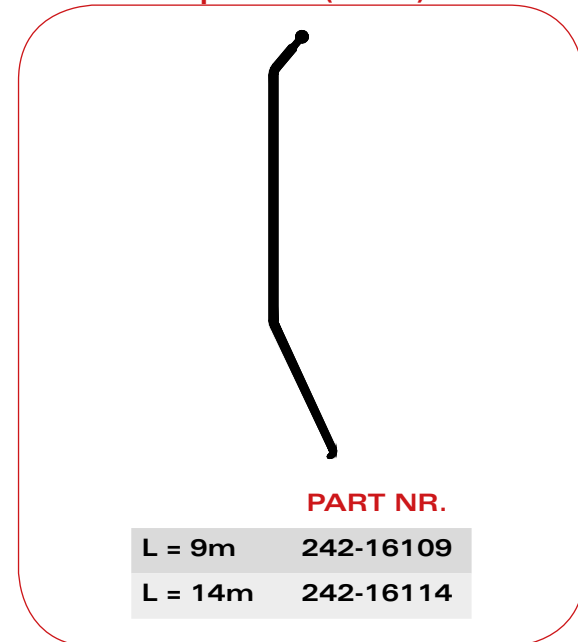

4a Back beam

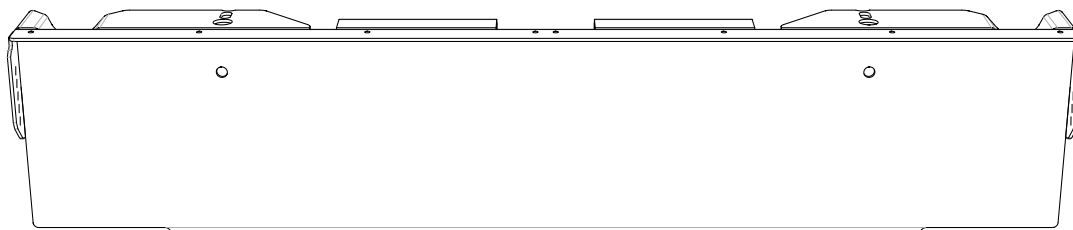

PART NR.

SB=2550 - 208Z	193-18001
Mounting set	144-10022

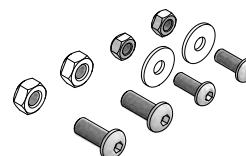

4b Back beam

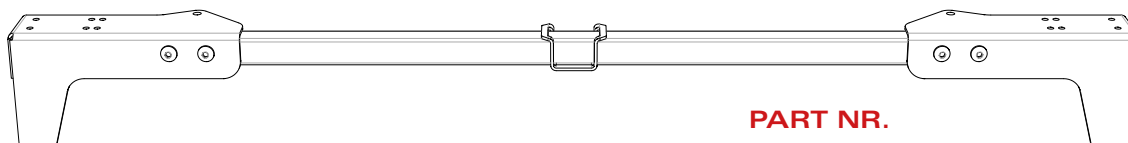

PART NR.

Set back beam tube 30x30mm	144-10037
Tube 30x30x2mm	112-07001

Rain strip for back beam (4a)



PART NR.

SB=2550	192-01601
---------	-----------

Rain strip for front header

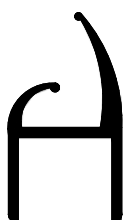
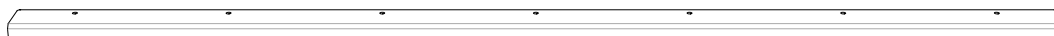

ttwin

PART NR.

Rain strip SB=2550	192-01606
PVC pelmet L = 2,6m (black)	242-20001
Mounting strip 30x5mm L= 2,6m	292-07001

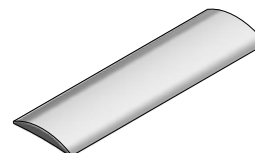

8 Folding plate

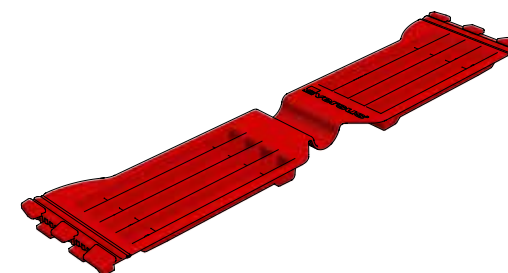

PART NR.

Type 400	242-01004
Type 500	242-01005
Type 600	242-01006
Type 700	242-01007
Type 570	242-01057
Type 650	242-01065

7a Set accessories

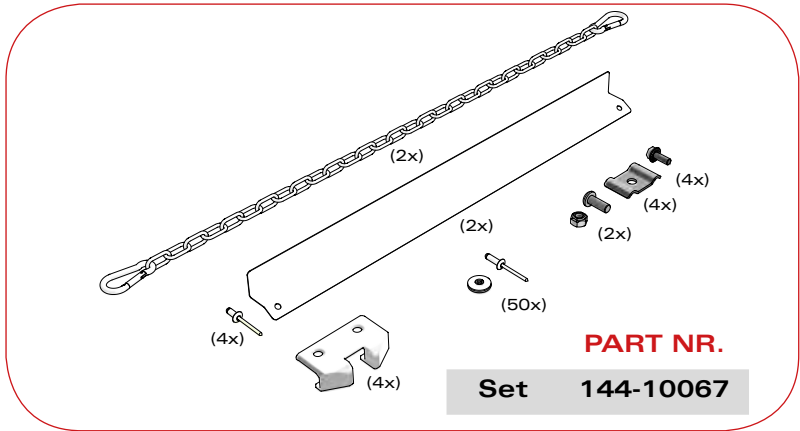

7b Set accessories Twin

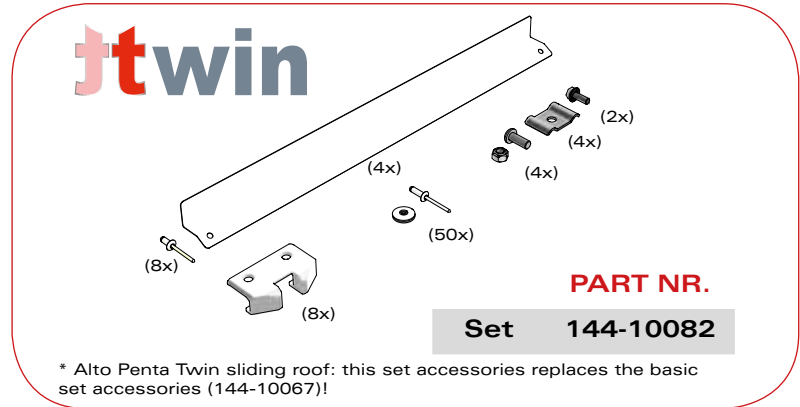

7c Set lock collapsible backside

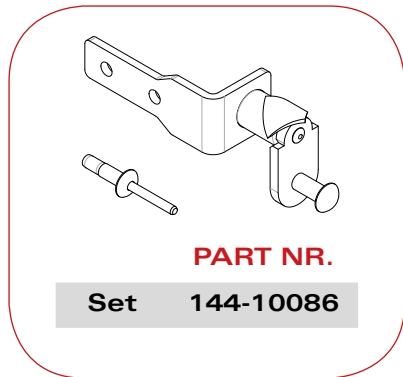

7d Set accessories external unlocking



9 Carapax plate



10 Pull bars & webbing

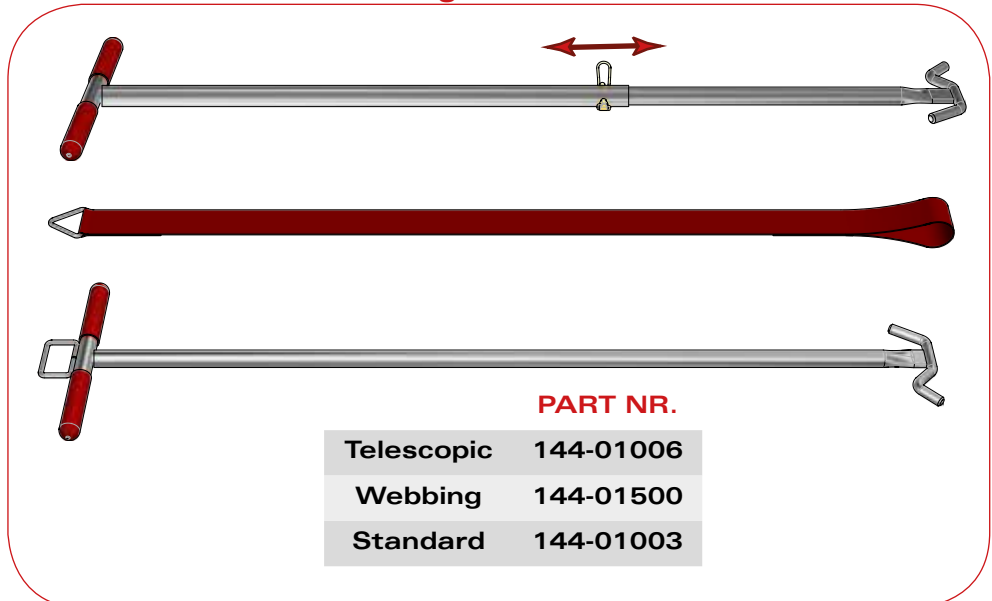

For roof sticks

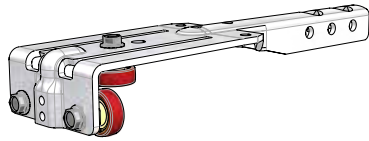

Assembled bracket

PART NR.

174-02001



Roller bearing plastic

PART NR.

132-01001



Bolt tensilock M6x16mm

PART NR.

091-23001

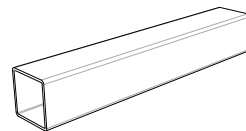

Tube 30x30x1,5mm

PART NR.

L = 2185mm 112-01003

For collapsible backside

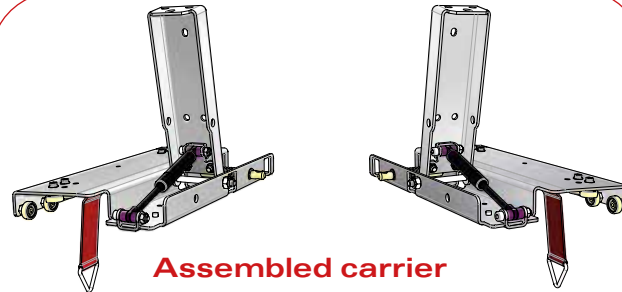

Assembled carrier

PART NR.

Left 204-47201

Right 204-47202

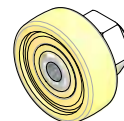

Roller bearing steel

PART NR.

132-03001



Bolt tensilock M6x16mm

PART NR.

091-23001

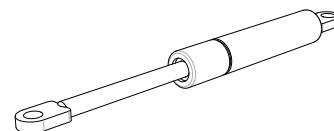

Gas spring 700N

PART NR.

302-01001

For accessories set

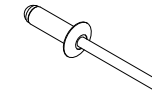

Rivet & washer

PART NR.

50 pieces 144-10003



Rope clamp

PART NR.

292-01001

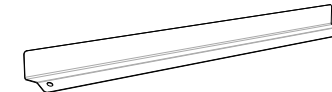

Protection plate

PART NR.

142-06006

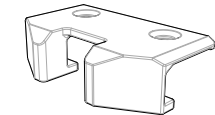

Locking nose

PART NR.

142-05020

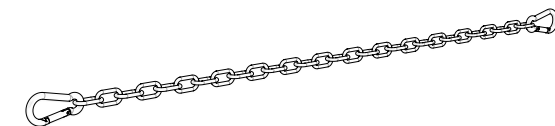

Chain with 2 hooks

PART NR.

142-07001

For mounting set

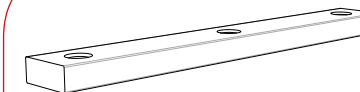

Mounting block

PART NR.

152-02001

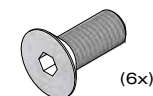

**Bolt
M10x25mm
(6x)**

PART NR.

091-26002



Versus-Omega
Nijverheidslaan 1527a
B-3660 Oudsbergen
Belgium

t. +32 89 320 190
f. +32 89 320 199
e. info@versus-omega.com
w. www.versus-omega.com

