



Revision: 01-10-19

Versus-omega preserves the right to alter parts and drawings at all times. Check online for the most recent updated versions.



Ω: PLANO

VS

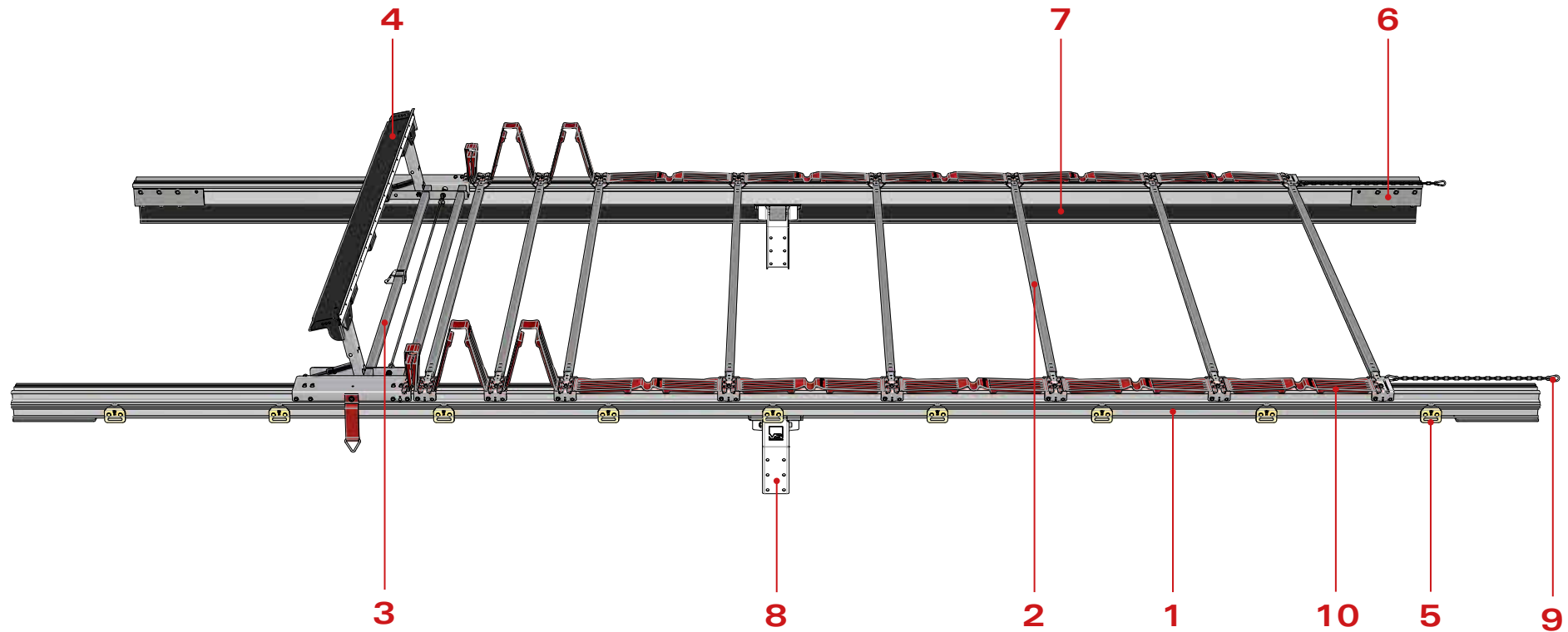

1	Plano rail
2	Roof stick
3	Collapsible backside
4	Back beam
5	Roller
6	Set mounting plates

7	PVC pelmet
8	Pillar bracket
9	Set accessories
10	Folding plate
11	Pull bar

1 Plano rail

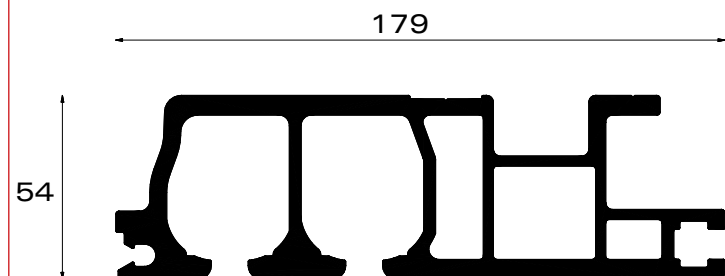

PART NR.

* L = 7,5m	162-05750
* L = 8,5m	162-05850
* L = 9,5m	162-05950
* L = 13,6m	162-05136

* profile with pre-bending

$I_x : 107\text{cm}^4$
 $I_y : 739\text{cm}^4$
 $\pm 7,5 \text{ kg/m}$

2a Roof stick for sliding roof



PART NR.

SB=2550 - Type SP	224-01031
SB=2550 - Type AS (Al)	224-03031

2b Roof stick for fixed roof with tarpaulin cover



PART NR.



SB=2550 - Type SP	224-01231
SB=2550 - Type AS (Al)	224-23231

* Roof stick fixed to rail with monobolts

3 Collapsible backside

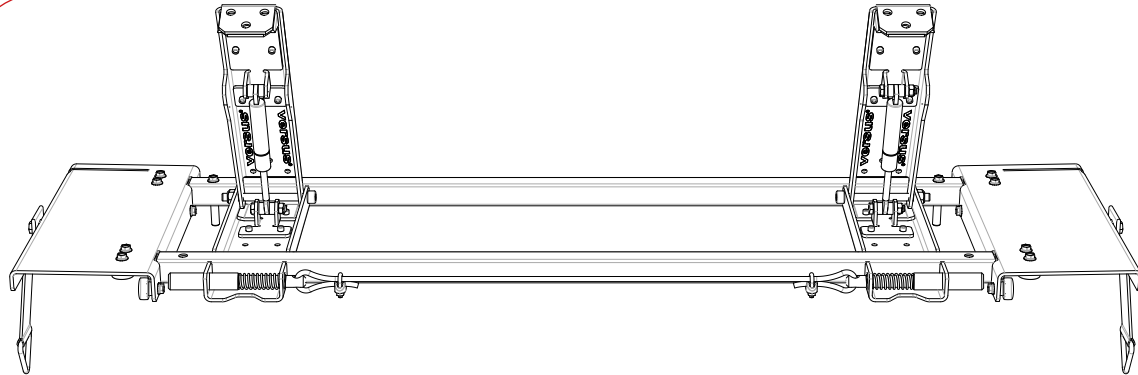

PART NR.

SB=2550 - L=52 214-03031

9a Set accessories

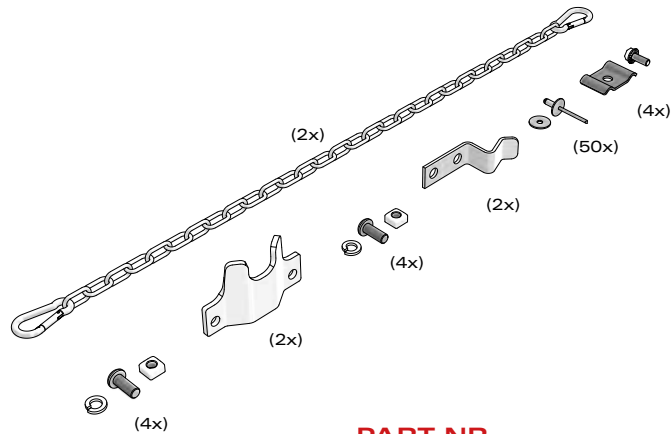

PART NR.

Set 144-10023

9b Set lock collapsible backside

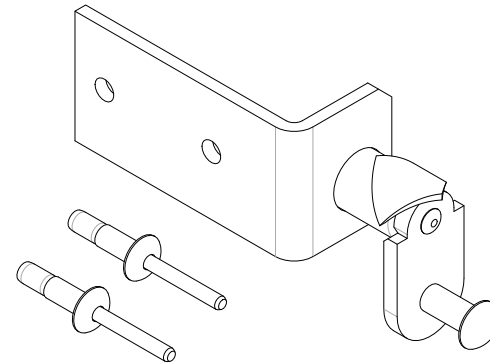

PART NR.

Set left 144-10008

Set right 144-10009

4 Back beam

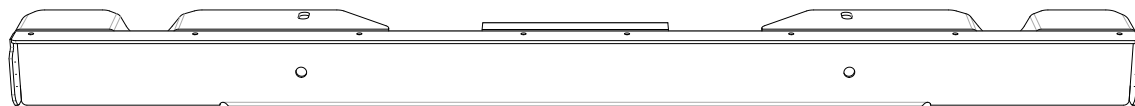

PART NR.	
SB=2550 - 80Z	193-05031
Mounting set	144-10022

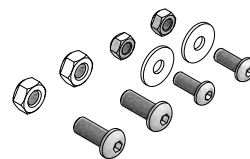

10 Folding plate

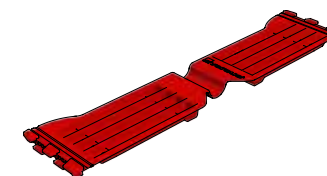

PART NR.	
Type 400	242-01004
Type 500	242-01005
Type 600	242-01006
Type 700	242-01007
Type 570	242-01057
Type 650	242-01065

Rain strip for back beam (4)



PART NR.	
SB=2550	192-01601

7a PVC pelmet (black)

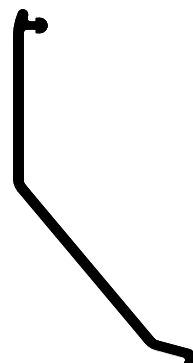

PART NR.	
L = 9m	242-12109
L = 14m	242-12114

* By sidecurtain roller 284-10002

7b PVC pelmet (black)

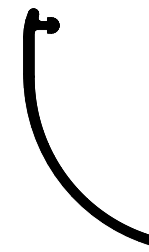

PART NR.	
L = 9m	242-15109
L = 14m	242-15114

* By sidecurtain roller 284-10007

11 Pull bars & webbing

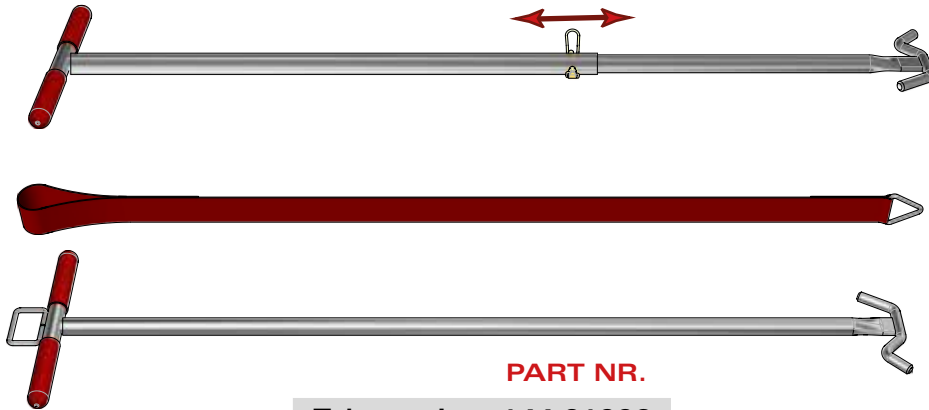

	PART NR.
Telescopic	144-01006
Webbing	144-01500
Standard	144-01003

8 Pillar bracket

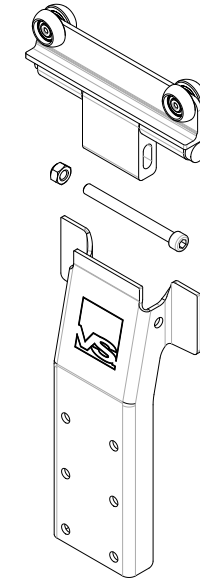

	PART NR.
Bracket	264-01002
Bolt & nut	144-10015
Plate	262-05007

6 Set mounting plates

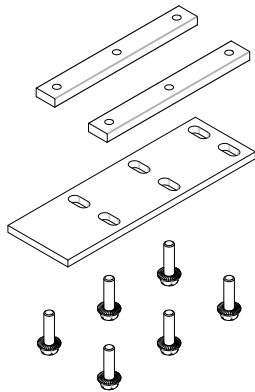

PART NR.
154-03001

* contains 4x the parts of the picture

5a Roller

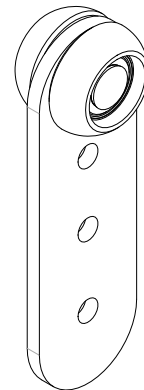

PART NR.
284-10002

5b Roller

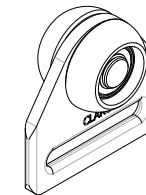

PART NR.
284-10007

For roof sticks

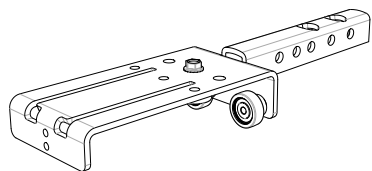

Assembled bracket

PART NR.

174-04031

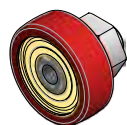

Roller bearing plastic

PART NR.

132-01001



Bolt tensilock M6x16mm

PART NR.

091-23001

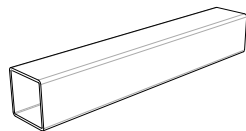

Tube 30x30x1,5mm

PART NR.

L = 2150mm 112-01003

For collapsible backside

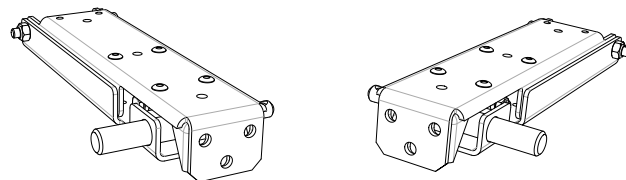

Assembled carrier

PART NR.

Left 254-01032

Right 254-01035

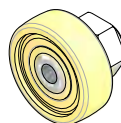

Roller bearing steel

PART NR.

132-03001



Bolt tensilock M6x16mm

PART NR.

091-23001

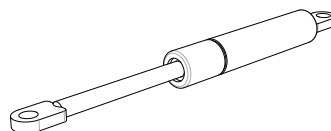

Gas spring 700N

PART NR.

302-01001

For accessories set

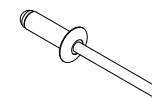

Rivet & washer

PART NR.

50 pieces 144-10003



Rope clamp

PART NR.

292-01001

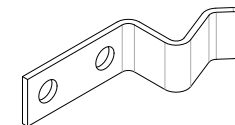

Locking nose front

PART NR.

142-05013

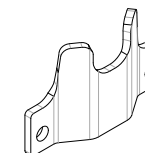

Locking nose back

PART NR.

142-05006



Chain with 2 hooks

PART NR.

142-07001

For mounting set

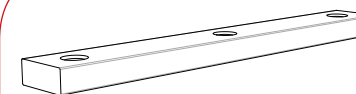

Mounting block

PART NR.

152-02001



**Bolt tensilock
M10x35mm**

PART NR.

091-23002



Versus-Omega

Nijverheidslaan 1527a
B-3660 Oudsbergen
Belgium

t. +32 89 320 190
f. +32 89 320 199
e. info@versus-omega.com
w. www.versus-omega.com

